

WorkSafe LT Rig Mats®

Strad is committed to helping develop North America's resources responsibly and safely. To do this, Strad is continually working to provide customers with **superior solutions and services** in the energy industry. Our manufacturing capabilities are just one area where we have made a name for ourselves as the leader for innovative and reliable matting products. Constantly challenging the status quo, Strad continues to provide advances in design, terrain adaptive features and construction materials that **increase safety, protect sensitive terrain and reduce project costs.**

WorkSafe LT Rig Mat®

Our WorkSafe LT Rig Mat® design is constructed with a cross-laminated timber (CLT) core that sets us apart from traditional matting fabrication. This next generation of rig mats eliminates the need for internal steel that is used in traditional 3-beam or 4-beam rig mat. Strad's square tube end provides a closer fit for mats and the steel is only required to protect the edge of the mat from exterior damage.

These mats can be used when moving walking rigs and ensuring safe drilling pads. Our matting products are designed to meet or exceed industry standards.

WorkSafe LT Rig Mat® Features

- Patented square tube ends
- Cross-laminated timber (CLT) core
- 8.5 ton lifting shackles and reinforced side lifting pockets
- Formed steel channel wrap

Cross-Laminated Timber (CLT) Benefits

- **30% lighter** than the traditional 3-beam steel-framed mats
- Four cross-laminated layers provides a solid platform with equal weight distribution
- CLT core provides a weight savings that allows for more mats per truck load
- Lightweight design and water-resistant properties of the CLT core offers customers a significant reduction in transport costs
- Reduces liquid penetration and contamination
- Constructed without nails, bolts, pins or sharp edges
- Panels can retain shape if bent, twisted or dropped
- Easy to clean

WorkSafe LT Rig Mat® Specifications:

Weight	5060 lbs / mat
Sizes	8' wide and up to 40' long
Thickness	5.75"
Load Capacity	70,000 + lbs/sq ft
Composition	Cross-Laminated Timber (CLT)
Fibre or Wood Used	SPF #2 and Douglas Fir #2

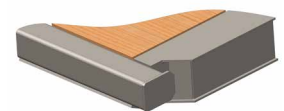

WorkSafe End

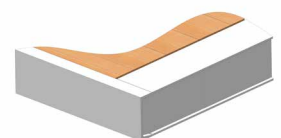

Box End

